

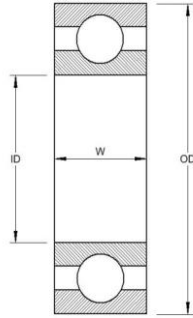

Farrell Bearings Limited

Imperial Bearing Conversion Sheet



FARRELL NO.	ALTERNATE NO.	SIZE
EE0 ZZ	R2 ZZ	1/8X3/8X5/32 INCH
EE1	R3	3/16X1/2X5/32 INCH
EE1 2RS	R3 2RS	3/16X1/2X0.1960 INCH
EE1 ZZ	R3 ZZ	3/16X1/2X0.1960 INCH
R4 2RS		1/4X5/8X3/16 INCH
R4 ZZ		1/4X5/8X3/16 INCH
EE2	R4A	1/4X3/4X7/32 INCH
EE2 2RS	R4A 2RSR	1/4X3/4X9/32 INCH
EE2 ZZ	R4A.ZZ	1/4X3/4X9/32 INCH
EE3	R6	3/8X7/8X7/32 INCH
EE3 2RS	R6 2RS	3/8X7/8X9/32 INCH
EE3 ZZ	R6 ZZ	3/8X7/8X9/32 INCH
EE4	R8	1/2X1 1/8X1/4 INCH
EE4 2RS	R8 2RSR	1/2X1 1/8X5/16 INCH
EE4 ZZ	R8 ZZ	1/2X1 1/8X5/16 INCH
EE5	R10	5/8X1 3/8X9/32 INCH
EE5 2RS	R10 2RS	5/8X1 3/8X11/32 INCH
EE5 ZZ	R10 ZZ	5/8X1 3/8X11/32 INCH
EE6	R12	3/4X1 5/8X5/16 INCH
EE6 2RS	R12 2RS	3/4X1 5/8X7/16 INCH
EE6 ZZ	R12 ZZ	3/4X1 5/8X7/16 INCH
EE7		3/4X1 3/4X3/8 INCH
EE7 2RS	1635 2RS	3/4X1 3/4X1/2 INCH
EE8	R14	7/8X1 7/8X3/8 INCH
EE8 2RS	R14 2RS	7/8X1 7/8X1/2 INCH
EE9	R16	1X2X3/8 INCH
EE9 2RS	R16 2RS	1X2X1/2 INCH
EE9 ZZ	R16 ZZ	1X2X1/2 INCH
EE10	R18	1 1/8X2 1/8X3/8 INCH
EE10 2RS	R18.2RS	1 1/8X2 1/8X1/2 INCH
EE10 ZZ	R18.ZZ	1 1/8X2 1/8X1/2 INCH
EE11	R20	1 1/4X2 1/4X3/8 INCH
EE11 2RS	R20 2RS	1 1/4X2 1/4X1/2 INCH
EE11 ZZ	R20.ZZ	1 1/4X2 1/4X1/2 INCH
EE12	R22	1 3/8X2 1/2X7/16 INCH
EE12 2RS	R22.2RS	1 3/8X2 1/2X9/16 INCH
EE13	R24	1 1/2X2 5/8X3/8 INCH
EE13 2RS	R24 2RS	1 1/2X2 5/8X1/2 INCH



Farrell Bearings Limited

Imperial Bearing Conversion Sheet

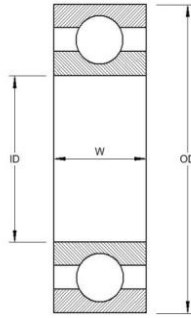

Imperial Deep Groove Ball Bearings

SKF	FAG/HOFFMAN	RHP	SIZE
RLS 4	LS 5	LJ 1/2	1/2X15/16X3/8 INCH
RLS 5	LS 7	LJ 5/8	5/8X1 9/16X7/16 INCH
RLS 6	LS 8	LJ 3/4	3/4X1 7/8X9/16 INCH
RLS 7	LS 9	LJ 7/8	7/8X2X9/16 INCH
RLS 8	LS 10	LJ 1	1X2 1/4X5/8 INCH
RLS 9	LS 11	LJ 1 1/8	1 1/8X2 1/2X5/8 INCH
RLS 10	LS 12	LJ 1 1/4	1 1/4X2 3/4X11/16 INCH
RLS 11	LS 12.1/2	LJ 1 3/8	1 3/8X3X11/16 INCH
RLS 12	LS 13	LJ 1 1/2	1 1/2X3 1/4X3/4 INCH
RLS 13	LS 13.1/2	LJ 1 5/8	1 5/8X3 1/2X3/4 INCH
RLS 14	LS 14	LJ 1 3/4	1 3/4X3 3/4X13/16 INCH
RLS 15	LS 14.1/2	LJ 1 7/8	1 7/8X4X13/16 INCH
RLS 16	LS 15	LJ 2	2X4X13/16 INCH
RLS 18	LS 16	LJ 2 1/4	2 1/4X4 1/2X7/8 INCH
RLS 20	LS 17	LJ 2 1/2	2 1/2X5X15/16 INCH
RLS 22	LS 18	LJ 2 3/4	2 3/4X5 1/4X15/16 INCH
RLS 24	LS 19	LJ 3	3X5 3/4X11/16 INCH
RLS 26	LS 19.1/2	LJ 3 1/4	3 1/4X6X1 1/16 INCH
RLS 28	LS 20	LJ 3 1/2	3 1/2X6 1/2X1 1/8 INCH
RLS 30	LS 20.1/2	LJ 3 3/4	3 3/4X6 3/4X1 1/8 INCH
RLS 32	LS 21	LJ 4	4X7 1/4X1 1/4 INCH
RLS 34	LS 21.1/2	LJ 4 1/4	4 1/4X7 1/2X1 1/4 INCH
RLS 36	LS 22	LJ 4 1/2	4 1/2X8X15/16 INCH
RLS 38	LS 22.1/2	LJ 4 3/4	4 3/4X8 1/4X1 5/16 INCH
RLS 40	LS 23	LJ 5	5X9X1 3/8 INCH
RLS 44	LS 23.1/2	LJ 5 1/2	5 1/2X9 1/2X1 3/8 INCH
RLS 48	LS 24	LJ 6	6X10 1/2X1 9/16 INCH
RLS 52	LS 24.1/2	LJ 6 1/2	6 1/2X11X1 9/16 INCH
RLS 56	LS 25	LJ 7	7X12X1 3/4 INCH
RLS 60	LS 25.1/2	LJ 7 1/2	7 1/2X12 1/2X1 3/4 INCH



Farrell Bearings Limited

Imperial Bearing Conversion Sheet

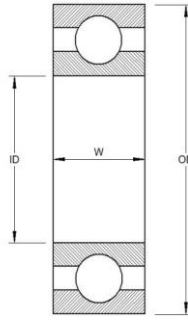

Imperial Deep Groove Ball Bearings

SKF	FAG/HOFFMAN	RHP	SIZE
RMS 4	MS 5	MJ 1/2	1/2X1 5/8X5/8 INCH
RMS 5	MS 7	MJ 5/8	5/8X1 13/16X5/8 INCH
RMS 6	MS 8	MJ 3/4	3/4X2X11/16 INCH
RMS 7	MS 9	MJ 7/8	7/8X2 1/4X11/16 INCH
RMS 8	MS 10	MJ 1	1X2 1/2X7/8 INCH
RMS 9	MS 11	MJ 1 1/8	1 1/8X2 13/16X13/16 INCH
RMS 10	MS 12	MJ 1 1/4	1 1/4X3 1/8X7/8 INCH
RMS 11	MS 12.1/2	MJ 1 3/8	1 3/8X3 1/2X7/8 INCH
RMS 12	MS 13	MJ 1 1/2	1 1/2X3 3/4X15/16 INCH
RMS 13	MS 13.1/2	MJ 1 5/8	1 5/8X4X15/16 INCH
RMS 14	MS 14	MJ 1 3/4	1 3/4X4 1/4X1 1/16 INCH
RMS 15	MS 14.1/2	MJ 1 7/8	1 7/8X4 1/2X1 1/16 INCH
RMS 16	MS 15	MJ 2	2X4 1/2X1 1/16 INCH
RMS 18	MS 16	MJ 2 1/4	2 1/4X5X1 1/4 INCH
RMS 20	MS 17	MJ 2 1/2	2 1/2X5 1/2X1 1/4 INCH
RMS 22	MS 18	MJ 2 3/4	2 3/4X6 1/4X1 3/8 INCH
RMS 24	MS 19	MJ 3	3X7X1 9/16 INCH
RMS 26	MS 19.1/2	MJ 3 1/4	3 1/4X7 1/2X1 9/16 INCH
RMS 28	MS 20	MJ 3 1/2	3 1/2X8 1/8X1 3/4 INCH
RMS 30	MS 20.1/2	MJ 3 3/4	3 3/4X8 1/4X1 3/4 INCH
RMS 32	MS 21	MJ 4	4X8 1/2X1 3/4 INCH
RMS 34	MS 21.1/2	MJ 4 1/4	4 1/4X8 3/4X1 3/4 INCH
RMS 36	MS 22	MJ 4 1/2	4 1/2X9 3/8X2 INCH
RMS 38	MS 22.1/2	MJ 4 3/4	4 3/4X10X2 INCH
RMS 40	MS 23	MJ 5	5X10X2 INCH
RMS 44	MS 23.1/2	MJ 5 1/2	5 1/2X11X2 INCH
RMS 48	MS 24	MJ 6	6X12X2 1/4 INCH
RMS 52	MS 24.1/2	MJ 6 1/2	6 1/2X13X2 1/2 INCH
RMS 56	MS 25	MJ 7	7X13 1/2X2 1/2 INCH
RMS 60	MS 25.1/2	MJ 7 1/2	7 1/2X14 1/2X2 3/4 INCH



Farrell Bearings Limited

Imperial Bearing Conversion Sheet

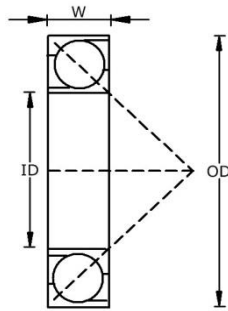

Imperial Angular Contact Ball Bearings

SKF	FAG/HOFFMAN	RHP	SIZE
ALS 4	LS.AC5	LJT 1/2	1/2X1 5/16X3/8 INCH
ALS 5	LS. AC 7	LJT 5/8	5/8X1 9/16X7/16 INCH
ALS 6	LS.AC8	LJT 3/4	3/4X1 7/8X9/16 INCH
ALS 7	LS. AC 9	LJT 7/8	7/8X2X9/16 INCH
ALS 8	LS. AC 10	LJT 1	1X2 1/4X5/8INCH
ALS 9	LS. AC 11	LJT 1 1/8	1 1/8X2 1/2X5/8 INCH
ALS 10	LS. AC 12	LJT 1 1/4	1 1/4X2 3/4X11/16 INCH
ALS 11	LS. AC 12.1/2	LJT 1 3/8	1 3/8X2X11/16 INCH
ALS 12	LS. AC 13	LJT 1 1/2	1 1/2X3 1/4X3/4 INCH
ALS 13	LS. AC 13.1/2	LJT 1 5/8	1 5/8X3 1/2X3/4 INCH
ALS 14	LS. AC 14	LJT 1 3/4	1 3/4X3 3/4X13/16 INCH
ALS 15	LS. AC 14.1/2	LJT 1 7/8	1 7/8X3 3/4X13/16 INCH
ALS 16	LS. AC 15	LJT 2	2X4X13/16 INCH
ALS 18	LS. AC 16	LJT 2 1/4	2 1/4X4 1/2X7/8 INCH
ALS 20	LS. AC 17	LJT 2 1/2	2 1/2X5X15/16 INCH
ALS 22	LS. AC 18	LJT 2 3/4	2 3/4X5 1/4X15/16 INCH
ALS 24	LS. AC 19	LJT 3	3X5 3/4X1 1/16 INCH
ALS 26	LS. AC 19.1/2	LJT 3 1/4	3 1/4X6X1 1/16 INCH
ALS 28	LS. AC 20	LJT 3 1/2	3 1/2X6 1/2X1 1/8 INCH
ALS 30	LS. AC 20.1/2	LJT 3 3/4	3 3/4X6 3/4X1 1/8 INCH
ALS 32	LS. AC 21	LJT 4	4X7 1/2X1 1/4 INCH
ALS 34	LS. AC 21.1/2	LJT 4 1/4	4 1/4X7 1/2X1 1/4 INCH
ALS 36	LS. AC 22	LJT 4 1/2	4 1/2X8X1 5/16 INCH
ALS 38	LS. AC 22.1/2	LJT 4 3/4	4 3/4X8 1/4X1 5/16 INCH
ALS 40	LS. AC 23	LJT 5	5X9X1 3/8 INCH
ALS 44	LS. AC 23.1/2	LJT 5 1/2	5 1/2X9 1/2X1 3/8 INCH
ALS 48	LS. AC 24	LJT 6	6X10 1/2X1 9/16 INCH
ALS 52	LS. AC 24.1/2	LJT 6 1/2	6 1/2X11X1 9/16 INCH
ALS 56	LS. AC 25	LJT 7	7X12X1 3/4 INCH
ALS 60	LS. AC 25.1/2	LJT 7 1/2	7 1/2X12 1/2X1 3/4 INCH



Farrell Bearings Limited

Imperial Bearing Conversion Sheet

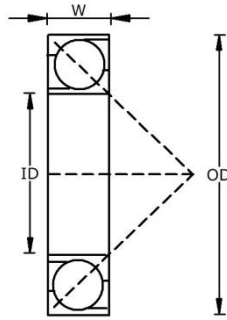

Imperial Angular Contact Ball Bearings

SKF	FAG/HOFFMAN	RHP	SIZE
AMS 4	MS.AC 5	MJT 1/2	1/2X1 5/8X5/8 INCH
AMS 5	MS.AC 7	MJT 5/8	5/8X1 13/16X5/8 INCH
AMS 6	MS.AC 8	MJT 3/4	3/4X2X11/16 INCH
AMS 7	MS.AC 9	MJT 7/8	7/8X2 1/4X11/16 INCH
AMS 8	MS.AC1 0	MJT 1	1X2 1/2X3/4 INCH
AMS 9	MS.AC 11	MJT 1 1/8	1 1/8X2 13/16X13/16 INCH
AMS 10	MS.AC 12	MJT 1 1/4	1 1/4X3 1/8X7/8 INCH
AMS 11	MS.AC 12.1/2	MJT 1 3/8	1 3/8X3 1/2X7/8 INCH
AMS 12	MS.AC 13	MJT 1 1/2	1 1/2X3 3/4X15/16 INCH
AMS 13	MS.AC 13.1/2	MJT 1 5/8	1 5/8X4X15/16 INCH
AMS 14	MS.AC 14	MJT 1 3/4	1 3/4X4 1/4X1 1/16 INCH
AMS 15	MS.AC 14.1/2	MJT 1 7/8	1 7/8X4 1/2X1 1/16 INCH
AMS 16	MS.AC 15	MJT 2	2X4 1/2X1 1/16 INCH
AMS 18	MS.AC 16	MJT 2 1/4	2 1/4X5X1 1/4 INCH
AMS 20	MS.AC 17	MJT 2 1/2	2 1/2X5 1/2X1 1/4 INCH
AMS 22	MS.AC 18	MJT 2 3/4	2 3/4X6 1/4X1 3/8 INCH
AMS 24	MS.AC 19	MJT 3	3X7X1 9/16 INCH
AMS 26	MS.AC 19.1/2	MJT 3 1/4	3 1/4X7 1/2X1 9/16 INCH
AMS 28	MS.AC 20	MJT 3 1/2	3 1/2X8 1/8X1 3/4 INCH
AMS 30	MS.AC 20.1/2	MJT 3 3/4	3 3/4X8 1/4X1 3/4 INCH
AMS 32	MS.AC 21	MJT 4	4X8 1/2X1 3/4 INCH
AMS 34	MS.AC 21.1/2	MJT 4 1/4	4 1/4X8 3/4X1 3/4 INCH
AMS 36	MS.AC 22	MJT 4 1/2	4 1/2X9 3/8X2 INCH
AMS 38	MS.AC 22.1/2	MJT 4 3/4	4 3/4X10X2 INCH
AMS 40	MS.AC 23	MJT 5	5X10X2 INCH
AMS 44	MS.AC 23.1/2	MJT 5 1/2	5 1/2X11X2 INCH
AMS 48	MS.AC 24	MJT 6	6X12X2 1/4 INCH
AMS 52	MS.AC 24.1/2	MJT 6 1/2	6 1/2X13X2 1/2 INCH
AMS 56	MS.AC 25	MJT 7	7X13 1/2X2 1/2 INCH
AMS 60	MS.AC 25.1/2	MJT 7 1/2	7 1/2X14 1/2X2 3/4 INCH



Farrell Bearings Limited

Imperial Bearing Conversion Sheet

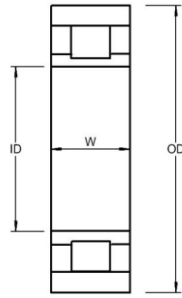

Imperial Cylindrical Roller Bearings

SKF	FAG/HOFFMAN	RHP	SIZE
CRL 4	RLS 5	LRJ 1/2	1/2X1 5/16X3/8 INCH
CRL 5	RLS 7	LRJ 5/8	5/8X1 9/16X7/16 INCH
CRL 6	RLS 8	LRJ 3/4	3/4X1 7/8X9/16 INCH
CRL 7	RLS 9	LRJ 7/8	7/8X2X9/16 INCH
CRL 8	RLS 10	LRJ 1	1X2 1/4X5/8 INCH
CRL 9	RLS 11	LRJ 1 1/8	1 1/8X2 1/8X5/8 INCH
CRL 10	RLS 12	LRJ 1 1/4	1 1/4X2 3/4X11/16 INCH
CRL 11	RLS 12.1/2	LRJ 1 3/8	1 3/8X3X11/16 INCH
CRL 12	RLS 13	LRJ 1 1/2	1 1/2X3 1/4X3/4 INCH
CRL 13	RLS 13.1/2	LRJ 1 5/8	1 5/8X3 1/2X3/4 INCH
CRL 14	RLS 14	LRJ 1 3/4	1 3/4X3 3/4X13/16 INCH
CRL 15	RLS 14.1/2	LRJ 1 7/8	1 7/8X4X13/16 INCH
CRL 16	RLS 15	LRJ 2	2X4X13/16 INCH
CRL 18	RLS 16	LRJ 2 1/4	2 1/4X4 1/2X7/8 INCH
CRL 20	RLS 17	LRJ 2 1/2	2 1/2X5X15/16 INCH
CRL 22	RLS 18	LRJ 2 3/4	2 3/4X5 1/4X15/16 INCH
CRL 24	RLS 19	LRJ 3	3X5 3/4X1 1/16 INCH
CRL 26	RLS 19.1/2	LRJ 3 1/4	3 1/4X6X1 1/16 INCH
CRL 28	RLS 20	LRJ 3 1/2	3 1/2X6 1/2X1 1/8 INCH
CRL 30	RLS 20.1/2	LRJ 3 3/4	3 3/4X6 3/4X1 1/8 INCH
CRL 32	RLS 21	LRJ 4	4X7 1/4X1 1/4 INCH
CRL 34	RLS 21.1/2	LRJ 4 1/4	4 1/4X7 1/2X1 1/4 INCH
CRL 36	RLS 22	LRJ 4 1/2	4 1/2X8X1 5/16 INCH
CRL 38	RLS 22.1/2	LRJ 4 3/4	4 3/4X8 1/4X1 5/16 INCH
CRL 40	RLS 23	LRJ 5	5X9X1 3/8 INCH
CRL 44	RLS 23.1/2	LRJ 5 1/2	5 1/2X9 1/2X1 3/8 INCH
CRL 48	RLS 24	LRJ 6	6X10 1/2X1 9/16 INCH
CRL 52	RLS 24.1/2	LRJ 6 1/2	6 1/2X11X1 9/16 INCH
CRL 56	RLS 25	LRJ 7	7X12X1 3/4 INCH
CRL 60	RLS 25.1/2	LRJ 7 1/2	7 1/2X12 1/2X1 3/4 INCH



Farrell Bearings Limited

Imperial Bearing Conversion Sheet

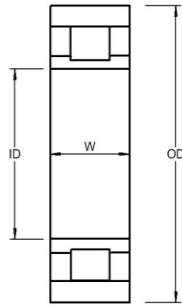

Imperial Cylindrical Roller Bearings

SKF	FAG/HOFFMAN	RHP	SIZE
CRM 4	RMS 5	MRJ 1/2	1/2X1 5/8X5/8 INCH
CRM 5	RMS 7	MRJ 5/8	5/8X1 13/16X5/8 INCH
CRM 6	RMS 8	MRJ 3/4	3/4X2X11/16 INCH
CRM 7	RMS 9	MRJ 7/8	7/8X2 1/4X11/16 INCH
CRM 8	RMS 10	MRJ 1	1X2 1/2X3/4 INCH
CRM 9	RMS 11	MRJ 1 1/8	1 1/8X2 13/16X13/16 INCH
CRM 10	RMS 12	MRJ 1 1/4	1 1/4X3 1/8X7/8 INCH
CRM 11	RMS 12.1/2	MRJ 1 3/8	1 3/8X3 1/2X7/8 INCH
CRM 12	RMS 13	MRJ 1 1/2	1 1/2X3 3/4X15/16 INCH
CRM 13	RMS 13.1/2	MRJ 1 5/8	1 5/8X4X15/16 INCH
CRM 14	RMS 14	MRJ 1 3/4	1 3/4X4 1/4X1 1/16 INCH
CRM 15	RMS 14.1/2	MRJ 1 7/8	1 7/8X4 1/2X1 1/16 INCH
CRM 16	RMS 15	MRJ 2	2X4 1/2X1 1/16 INCH
CRM 18	RMS 16	MRJ 2 1/4	2 1/4X5X1 1/4 INCH
CRM 20	RMS 17	MRJ 2 1/2	2 1/2X5 1/2X1 1/4 INCH
CRM 22	RMS 18	MRJ 2 3/4	2 3/4X6 1/4X1 3/8 INCH
CRM 24	RMS 19	MRJ 3	3X7X1 9/16 INCH
CRM 26	RMS 19.1/2	MRJ 3 1/4	3 1/4X7 1/2X1 9/16 INCH
CRM 28	RMS 20	MRJ 3 1/2	3 1/2X8 1/8X1 3/4 INCH
CRM 30	RMS 20.1/2	MRJ 3 3/4	3 3/4X8 1/4X1 3/4 INCH
CRM 32	RMS 21	MRJ 4	4X8 1/2X1 3/4 INCH
CRM 34	RMS 21.1/2	MRJ 4 1/4	4 1/4X8 3/4X1 3/4 INCH
CRM 36	RMS 22	MRJ 4 1/2	4 1/2X9 3/8X2 INCH
CRM 38	RMS 22.1/2	MRJ 4 3/4	4 3/4X10X2 INCH
CRM 40	RMS 23	MRJ 5	5X10X2 INCH
CRM 44	RMS 23.1/2	MRJ 5 1/2	5 1/2X11X2 INCH
CRM 48	RMS 24	MRJ 6	6X12X2 1/4 INCH
CRM 52	RMS 24.1/2	MRJ 6 1/2	6 1/2X13X2 1/2 INCH
CRM 56	RMS 25	MRJ 7	7X13 1/2X2 1/2 INCH
CRM 60	RMS 25.1/2	MRJ 7 1/2	7 1/2X14 1/2X2 3/4 INCH



Farrell Bearings Limited

Imperial Bearing Conversion Sheet

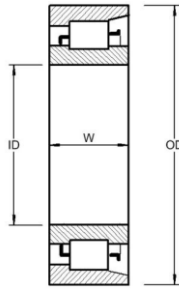

Imperial Cylindrical Roller Bearings

SKF	FAG/HOFFMAN	RHP	SIZE
CFL 4	RL.L 5	LRJA 1/2	1/2X1 5/16X3/8 INCH
CFL 5	RL.L 7	LRJA 5/8	5/8X1 9/16X7/16 INCH
CFL 6	RL.L 8	LRJA 3/4	3/4X1 7/8X9/16 INCH
CFL 7	RL.L 9	LRJA 7/8	7/8X2X9/16 INCH
CFL 8	RL.L 10	LRJA 1	1X2 1/4X5/8 INCH
CFL 9	RL.L 11	LRJA 1 1/8	1 1/8X2 1/2X5/8 INCH
CFL 10	RL.L 12	LRJA 1 1/4	1 1/4X2 3/4X11/16 INCH
CFL 11	RL.L 12.1/2	LRJA 1 3/8	1 3/8X3X11/16 INCH
CFL 12	RL.L 13	LRJA 1 1/2	1 1/2X3 1/4X3/4 INCH
CFL 13	RL.L 13.1/2	LRJA 1 5/8	1 5/8X3 1/2X3/4 INCH
CFL 14	RL.L 14	LRJA 1 3/4	1 3/4X3 3/4X13/16 INCH
CFL 15	RL.L 14.1/2	LRJA 1 7/8	1 7/8X4X13/16 INCH
CFL 16	RL.L 15	LRJA 2	2X4X13/16 INCH
CFL 18	RL.L 16	LRJA 2 1/4	2 1/4X4 1/2X7/8 INCH
CFL 20	RL.L 17	LRJA 2 1/2	2 1/2X5X15/16 INCH
CFL 22	RL.L 18	LRJA 2 3/4	3/4X5 1/4X15/16 INCH
CFL 24	RL.L 19	LRJA 3	3X5 3/4X1 1/16 INCH
CFL 26	RL.L 19.1/2	LRJA 3 1/4	3 1/4X6X1 1/16 INCH
CFL 28	RL.L 20	LRJA 3 1/2	3 1/2X6 1/2X1 1/8 INCH
CFL 30	RL.L 20.1/2	LRJA 3 3/4	3 3/4X6 3/4X1 1/8 INCH
CFL 32	RL.L 21	LRJA 4	4X7 1/4X1 1/4 INCH
CFL 34	RL.L 21.1/2	LRJA 4 1/4	4 1/4X7 1/2X1 1/4 INCH
CFL 36	RL.L 22	LRJA 4 1/2	4 1/2X8X1 5/16 INCH
CFL 38	RL.L 22.1/2	LRJA 4 3/4	4 3/4X8 1/4X1 5/16 INCH
CFL 40	RL.L 23	LRJA 5	5X9X1 3/8 INCH
CFL 44	RL.L 23.1/2	LRJA 5 1/2	5 1/2X9 1/2X1 3/8 INCH
CFL 48	RL.L 24	LRJA 6	6X10 1/2X1 9/16 INCH
CFL 52	RL.L 24.1/2	LRJA 6 1/2	6 1/2X11X1 9/16 INCH
CFL 56	RL.L 25	LRJA 7	7X12X1 3/4 INCH
CFL 60	RL.L 25.1/2	LRJA 7 1/2	7 1/2X12 1/2X1 3/4 INCH



Farrell Bearings Limited

Imperial Bearing Conversion Sheet

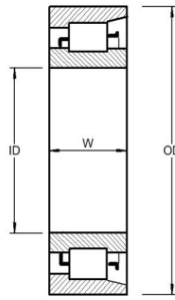

Imperial Cylindrical Roller Bearings

SKF	FAG/HOFFMAN	RHP	SIZE
CFM 4	RM.L 5	MRJA 1/2	1/2X1 5/8X5/8 INCH
CFM 5	RM.L 7	MRJA 5/8	5/8X1 13/16X5/8 INCH
CFM 6	RM.L 8	MRJA 3/4	3/4X2X11/16 INCH
CFM 7	RM.L 9	MRJA 7/8	7/8X2 1/4X11/16 INCH
CFM 8	RM.L 10	MRJA 1	1X2 1/2X3/4 INCH
CFM 9	RM.L 11	MRJA 1 1/8	1 1/8X2 13/16X13/16 INCH
CFM 10	RM.L 12	MRJA 1 1/4	1 1/4X3 1/8X7/8 INCH
CFM 11	RM.L 12.1/2	MRJA 1 3/8	1 3/8X3 1/2X7/8 INCH
CFM 12	RM.L 13	MRJA 1 1/2	1 1/2X3 3/4X15/16 INCH
CFM 13	RM.L 13.1/2	MRJA 1 5/8	1 5/8X4X15/16 INCH
CFM 14	RM.L 14	MRJA 1 3/4	1 3/4X4 1/4X1 1/16 INCH
CFM 15	RM.L 14.1/2	MRJA 1 7/8	1 7/8X4 1/2X1 1/16 INCH
CFM 16	RM.L 15	MRJA 2	2X4 1/2X1 1/16 INCH
CFM 18	RM.L 16	MRJA 2 1/4	2 1/4X5X1 1/4 INCH
CFM 20	RM.L 17	MRJA 2 1/2	2 1/2X5 1/8X1 1/4 INCH
CFM 22	RM.L 18	MRJA 2 3/4	2 3/4X6 1/4X1 3/8 INCH
CFM 24	RM.L 19	MRJA 3	3X7X1 9/16 INCH
CFM 26	RM.L 19.1/2	MRJA 3 1/4	3 1/4X7 1/2X1 9/16 INCH
CFM 28	RM.L 20	MRJA 3 1/2	3 1/2X8 1/8X1 3/4 INCH
CFM 30	RM.L 20.1/2	MRJA 3 3/4	3 3/4X8 1/4X1 3/4 INCH
CFM 32	RM.L 21	MRJA 4	4X8 1/2X1 3/4 INCH
CFM 34	RM.L 21.1/2	MRJA 4 1/4	4 1/4X8 3/4X1 3/4 INCH
CFM 36	RM.L 22	MRJA 4 1/2	4 1/2X9 3/8X2 INCH
CFM 38	RM.L 22.1/2	MRJA 4 3/4	4 3/4X10X2 INCH
CFM 40	RM.L 23	MRJA 5	5X10X2 INCH
CFM 44	RM.L 23.1/2	MRJA 5 1/2	5 1/2X11X2 INCH
CFM 48	RM.L 24	MRJA 6	6X12X2 1/4 INCH
CFM 52	RM.L 24.1/2	MRJA 6 1/2	6 1/2X13X2 1/2 INCH
CFM 56	RM.L 25	MRJA 7	7X13 1/2X2 1/2 INCH
CFM 60	RM.L 25.1/2	MRJA 7 1/2	7 1/2X14 1/2X2 3/4 INCH